



INSTALLATION INSTRUCTIONS

THREADED AND BOLT-ON ALUMINUM OIL CAP

- K21-303-00: 5,200 - 8,000 LBS. THREADED CAP**
- K21-302-00: 9,000 - 10,000 GD LBS. THREADED CAP**
- K21-259-00: 9,000 - 12,000 LBS. BOLT-ON CAP**
- K21-301-00: 10,000 HD - 15,000 LBS. THREADED CAP**
- K21-304-00: 10,000 - 16,000 LBS. THREADED CAP**
- K21-305-00: 10,000 - 16,000 LBS. THREADED CAP**

BEFORE BEGINNING, INSPECT THE NEW CAP. IF DAMAGE IS PRESENT, STOP PROCESS IMMEDIATELY AND CONTACT SUPPLIER FOR REPLACEMENT.

IT IS THE CUSTOMER'S RESPONSIBILITY TO ENSURE THAT THE CAP MATCHES THE HUB SPECIFICATIONS FOR THE TRAILER.



CAUTION

DO NOT LIFT OR SUPPORT THE TRAILER ON ANY PART OF THE AXLE OR SUSPENSION SYSTEM. NEVER GO UNDER ANY TRAILER UNLESS IT IS PROPERLY SUPPORTED ON JACK STANDS WHICH HAVE BEEN RATED FOR THE LOAD. IMPROPERLY SUPPORTED VEHICLES CAN FALL UNEXPECTEDLY AND CAUSE SERIOUS INJURY OR DEATH.

DEXTER REQUIRES MAINTENANCE EVERY 12 MONTHS OR 12,000 MILES. IF YOU ARE AT A MAINTENANCE INTERVAL, BE PREPARED TO DISASSEMBLE WHEEL END AND REPACK BEARINGS.

RECOMMENDED TOOLS

- 6 mm Allen socket
- Ratchet or breaker bar
- Clean, lint-free cloth or rag
- Clean plastic paint scraper
- Lubricant

THREADED ONLY:

- 2.5" socket attachment, 6-point
- 5 - 40 ft.-lbs. range torque wrench

BOLT-ON ONLY:

- 5 mm Allen socket attachment
- 5 - 10 ft.-lbs. range torque wrench

LUBRICATION SPECIFICATIONS

- SAE 90, SAE 80W-90, or SAE 75W-90 oil
- Dexter Grease (088-012-00) or equivalent lithium NLGI #2 complex

THREADED CAP INSTALLATION

- Drain oil from existing cap and properly dispose of oil. Caps utilizing grease do not need drained before cap removal.
- Remove the existing cap, using a 2.5" socket, 6-point and a ratchet or breaker bar. Then unscrew the cap counterclockwise while keeping the hub stationary.
- Inspect hub and cap mating surfaces for lubrication and debris. Wipe clean using a clean cloth, rag, or plastic paint scraper. Be careful not to damage the sealing surfaces when scraping off stubborn dirt material.
- For grease applications, visually inspect hub opening for presences of grease and it's condition. If grease is present and in good condition, continue to step 5. If there is minimal to no grease or the grease is contaminated, bearings with need repacked following instructions in Dexter's service manuals. Do not proceed with installation without completing repacking.
- Apply a thin layer of oil on the hub side of the o-ring.

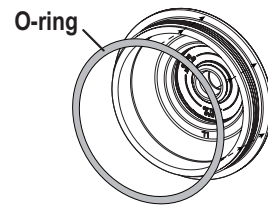

- Position the cap over the hub opening and ensure threads are aligned to prevent cross-threading. Hand-tighten clockwise until snug.
- Using a 2.5" socket, torque the cap to the specification indicated on the cap.
- For standard grease applications, installation is complete. For oil applications, continue to oil lubrication section.

BOLT-ON CAP INSTALLATION

- Drain oil from existing cap and properly dispose of oil. Caps utilizing grease do not need drained before cap removal.
- Remove the existing cap, using the 5 mm Allen socket and a ratchet or breaker bar. Then unbolt the cap while keeping the hub stationary.
- Inspect hub and cap mating surfaces for lubrication and debris. Wipe clean using a clean cloth, rag, or plastic paint scraper. Be careful not to damage the sealing surfaces when scraping off stubborn dirt material.
- For grease applications, visually inspect hub opening for presences of grease and it's condition. If grease is present and in good condition, continue to step 4. If there is minimal to no grease or the grease is contaminated, bearings with need repacked following instructions in Dexter's service manuals. Do not proceed with installation without completing repacking.

- Align the bolt holes in the cap and gasket then align with hub.

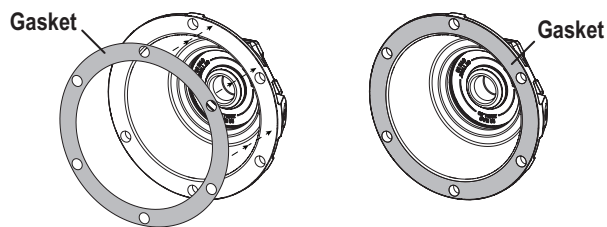

- Ensure bolt is precoated and the lock washer installed. If not, install lock washer then apply Loctite® 516/517.
- Begin to thread bolts by hand, through the assembly and then hand-tighten clockwise until snug.

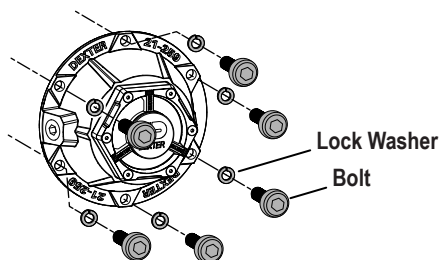

- Using a 5 mm Allen socket, torque the bolts to 6 - 8 ft.-lbs.
- For standard grease applications, installation is complete. For oil applications, continue to oil lubrication section.

OIL LUBRICATION

The cap can be filled with oil from either the front or side plug.

- Gently remove the front or side plug by hand.
- Fill cap with oil matching the indicator fill lines.
- If using front plug, replace plug into the cap and skip to step 6.
- If using side plug, apply Loctite® 516/517 sealant to the threads before reinstalling. Failure to reapply the sealant could result in oil leaks.
- Replace side plug and torque 5-6 ft-lb. using a 6 mm Allen socket.

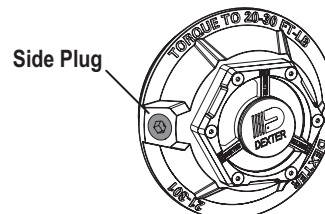

- After filling, spin the hub and recheck the oil level through the level indicators on the clear viewing lens. If level has changed, there may be a gap between the hub and seal.
- Using a clean cloth or rag, wipe off any excess lubricant or dirt around the cap.

SCAN FOR DEXTER'S
SERVICE MANUALS



SCAN FOR MORE
INFORMATION ON
DEXTER'S FORTRESS
PRODUCT LINE

